

SECTION

BLIND FLANGE:
16" 150# DRILLING
SUPPLIED BY JCM

16" LINE STOP
PLUG

FLANGE: 16" LINE STOP
ANSI B16.5 150# RFWN
SUPPLIED BY JCM

TEST PORT:
3/4" IP, 3000#

NECK, PLATE:
3/8" THK, CS

BOLTS:
3/4" TRACK
ON 4" CENTERS

BODY, PLATE:
3/8" THK, CS

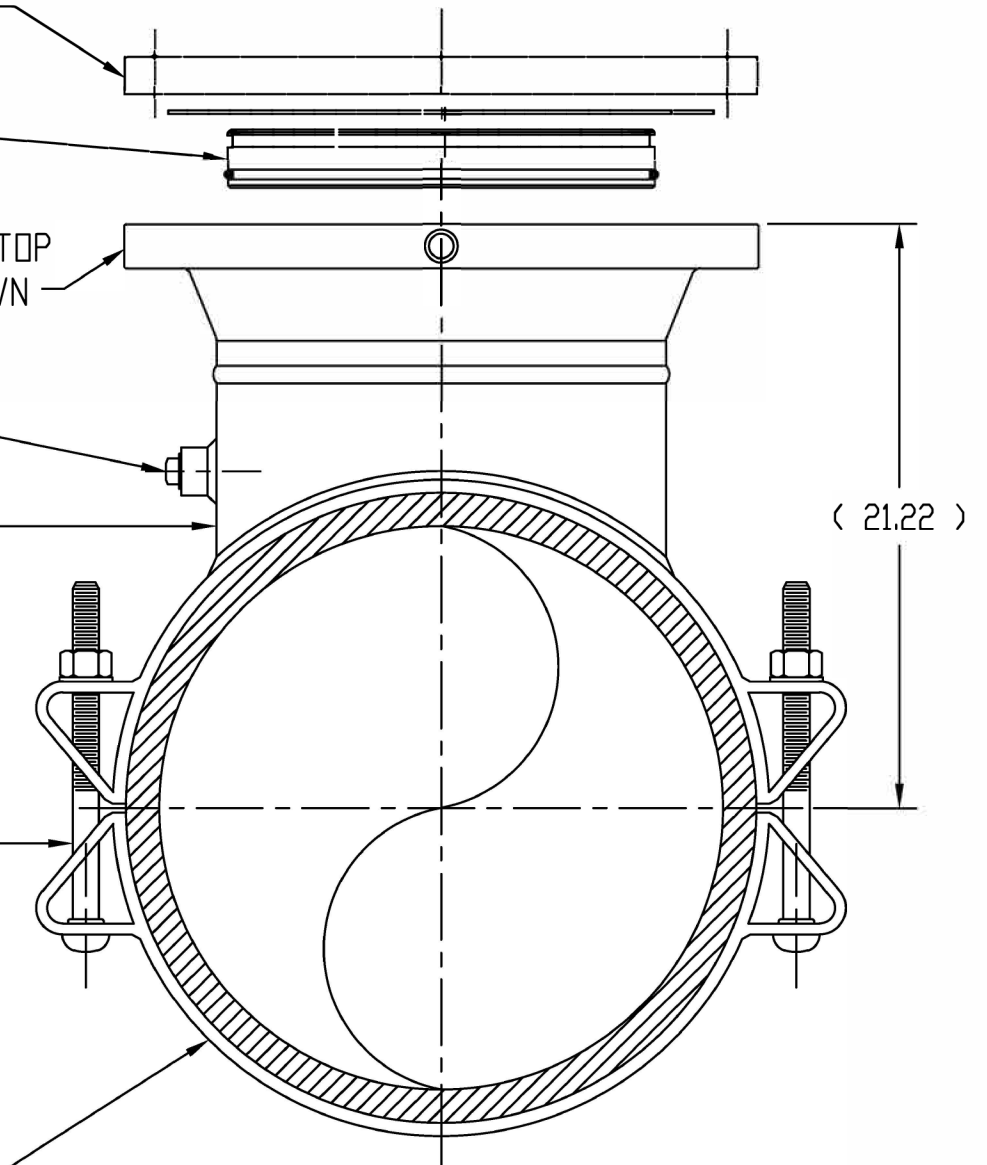

END VIEW

NOTES:

1. DESIGN & FAB. PER AWWA C-223
2. WORKING PRESSURE: 150 PSI
3. FINISH: FUSION EPOXY COAT
4. FASTENERS: 304 SS
5. FABRICATE TO
LINE STOP ACCURACY

THIS DRAWING INCLUDING ALL NOVEL AND PATENTED OR
PATENTABLE SUBJECT MATTER EMBODIES CONFIDENTIAL
INFORMATION OF JCM INDUSTRIES, INC. AND IS LOANED WITH
THE UNDERSTANDING THAT IT WILL NOT BE REPRODUCED
NOR BE USED FOR ANY PURPOSE EXCEPT FOR WHICH LOANED
UNLESS WRITTEN PERMISSION IS GRANTED BY THE OWNER
AND THAT IT SHALL BE RETURNED UPON DEMAND.

						<div>JCM</div> <div>JCM INDUSTRIES, INC. NASH, TX.</div>	440-24" X 16" T12 ESS								
							FLANGED OUTLET TAPPING SLEEVE - LINE STOP ACCURACY								
							UNLESS OTHERWISE SPECIFIED TOLERANCES TO BE	DRAWN BY RTM	CHECKED BY -----	APVD. BY -----	DWG. NO. GEN-009598	REV. --			
							FRACTIONSDECIMALSANGLES	DATE	NO. SHEETS	SCALE	PART NO.				
REVISIONS						P.O. BOX 1220 NASH, TX 75569 www.jcmindustries.com	OFFICE: (903) 832-2581 TOLL FREE: (800) 527-8482 FAX: (800) 874-9524	+ 1/8"	.063	2°	11/21/13	1 of 1			